

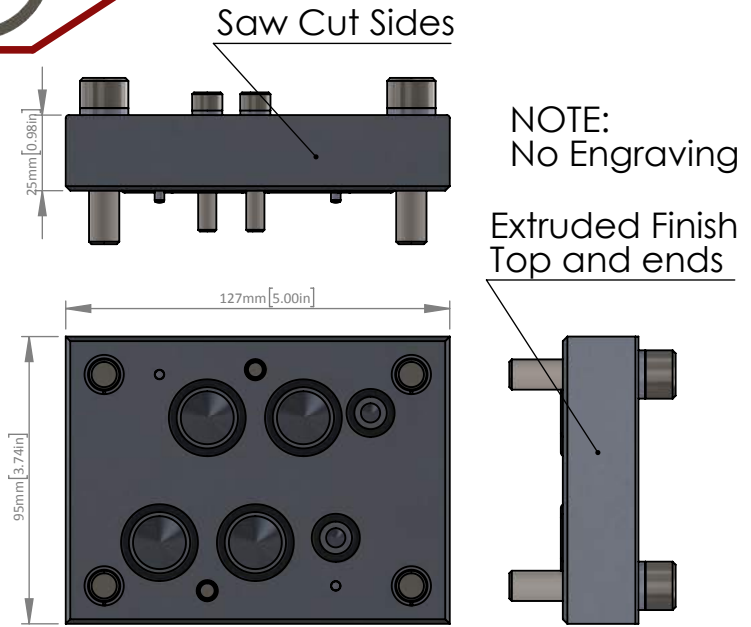

**NG16 / D07 : All Ports Blocked**

Interface Conforms to: ISO 4401-07-07-0-05  
 Aluminum P/N: ECVP-NG16-XX-X-AA-XX-A  
 Ductile P/N: ECVP-NG16-XX-X-DA-XX-A

ITEM NO.	QTY.	PART NUMBER	DESCRIPTION
1	1	ECVP-NG16-XX-X-_-XX-A	NG16 D07 E-Cover Plate, All Blocked
2	4	BOLT-SHC-M10x45-C-BA-129	M10 x 45 Long Socket Head Cap Screw
3	4	WASH-HCL-M10-BA	High Collar Lock Washer, M10
4	2	BOLT-SHC-M6x40-C-BA-129	M6 x 40 Long Socket Head Cap Screw
5	2	WASR-HCL-M06-2-BA	High Collar Lock Washer, M6
6	2	SEAL-ORG-BA-A-111	O-Ring, Buna-N, 70 Duro, -111
7	4	SEAL-ORG-BA-A-117	O-Ring, Buna-N, 70 Duro, -117
8	2	PIN-DP-1_8x375	1/8 x 3/8 Long Dowel Pin



**NG25 / D08 : All Ports Blocked**

Interface Conforms to: ISO 4401-08-08-0-05  
 Aluminum P/N: ECVP-NG25-XX-X-AA-XX-A  
 Ductile P/N: ECVP-NG25-XX-X-DA-XX-A

ITEM NO.	QTY.	PART NUMBER	DESCRIPTION
1	1	ECVP-NG25-XX-X-_-XX-A	NG16 D07 E-Cover Plate, All Blocked
2	6	BOLT-SHC-M12x45-C-BA-129	M12 x 45 Long Socket Head Cap Screw
3	6	WASR-HCL-M12-BA	High Collar Lock Washer, M12
4	4	SEAL-ORG-BA-A-121	O-Ring, Buna-N, 70 Duro, -121
5	2	SEAL-ORG-BA-A-114	O-Ring, Buna-N, 70 Duro, -114
6	2	PIN-DP-M05X14	M5 x 14mm Long Dowel Pin

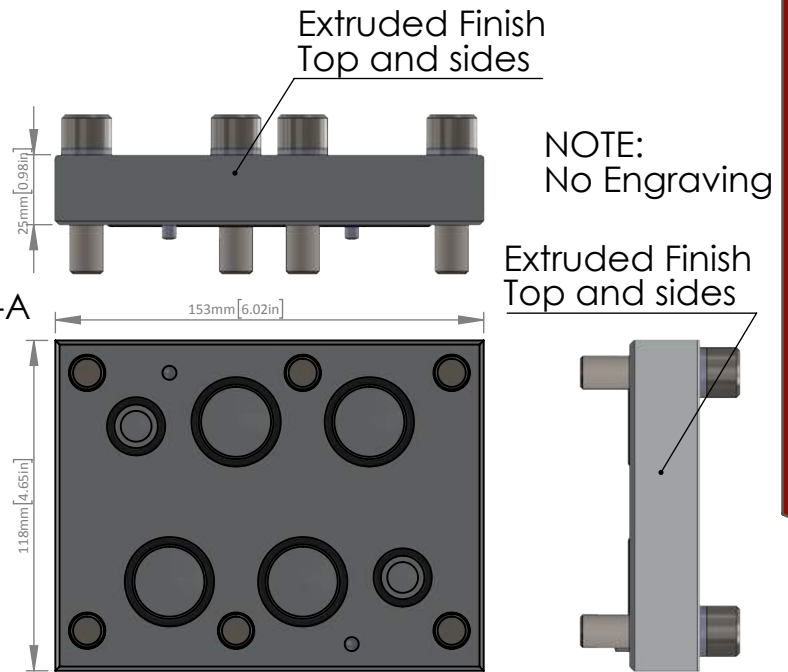

ECVP: E-Cover Plates

ECVP: E-Cover Plates

<b>ECVP-</b>	<b>***_</b>	<b>XX-</b>	<b>X-</b>	<b>**_</b>	<b>XX-</b>	<b>A</b>
<ul style="list-style-type: none"> <li>Product Family</li> <li>Economy CoVer Plate</li> </ul>	<ul style="list-style-type: none"> <li>BAR Size</li> <li>NG16 (D07)</li> <li>NG25 (D08)</li> </ul>	<ul style="list-style-type: none"> <li>Connection option</li> <li>XX: All Ports Blocked</li> </ul>	<ul style="list-style-type: none"> <li>Port Type</li> <li>X: None</li> </ul>	<ul style="list-style-type: none"> <li>Material</li> <li>AA: Aluminum                             <ul style="list-style-type: none"> <li>6061T6</li> <li>210 BAR</li> </ul> <li>DA: Ductile Iron                             <ul style="list-style-type: none"> <li>654512</li> <li>350 BAR</li> </ul> </li> </li></ul>	<ul style="list-style-type: none"> <li>Surface Finish</li> <li>XX: Bare Metal</li> <li>Special Surface Finish Options Available Upon Special Request</li> </ul>	<ul style="list-style-type: none"> <li>Design Variant</li> <li>A: Design A</li> </ul>

Subject to Change: CTLG-01-001A